

MASONIC SOURCE & EXHIBITION



CATHEDRAL WORCESTER

AUGUST 27th 1884

General Directions.



The Cloak-rooms for Ladies are on the first landing. The Green-Room at the foot of principal staircase, and the Sessions Court adjoining, are set apart as Hat and Robing Rooms for Brethren.

The Brethren acting as Stewards, and who are distinguished by a white rosette on the left shoulder, will render every assistance to guests.

In order to avoid inconvenience or crush, it is hoped visitors will as far as possible circulate through the various apartments in the order indicated on the subjoined plan.

The Museum and Exhibition occupies both New and Old Council Chambers. A fully descriptive Catalogue of the 1,200 Exhibits, with Historical Notes by W. J. Hughan, may be procured from the attendant in the upper corridor, price 2/6 each.

Refreshments will be served during the whole evening in the Lower Hall.

Synner & Gilmer's Orchestral Band.

—♦♦♦—
Conductor - Bro. Alfred W. Gilmer
—♦♦♦—

- War March - - "Athalie." - - Mendelssohn.
Overture - - - "Zanetta." - - Auber.
Valse (first time) "Grand Lodge of England." Godfrey.
Berceuse (for Strings only) - - Delbruck.
Grand Selection - "Neil Gwynne." - - Planquette.
L'Invitation a la Valse - - - - Weber.
Cornet Solo "Cujus Animam." - - Rossini.
Grand Selection - "Princess Ida." - - Sullivan.
Bolero - - "Almaviva." - - Mollandaine.
Overture - - "Guillaume Tell." - - Rossini.
Cornet Solo - "The Lost Chord." - Sullivan.
Grand Selection - "Mignon." - - Thomas.

—
God Save the Queen.

PLAN OF ASSEMBLY & EXHIBITION ROOMS.

N.B.—THE DARTS INDICATE THE COURSE
TO BE OBSERVED IN CIRCULATING
THROUGH THE ROOMS.

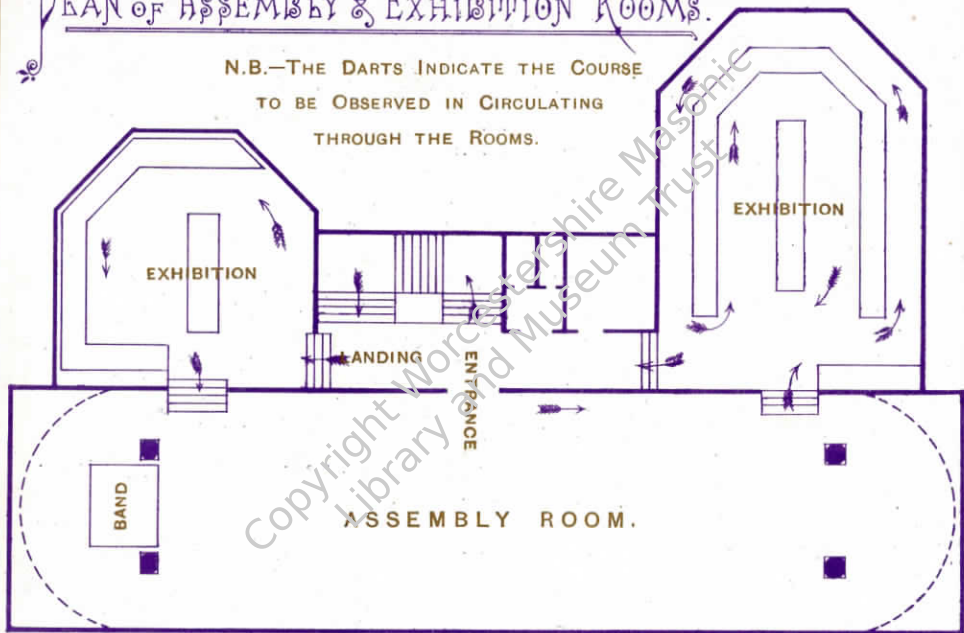

Copyright Worcester-shire Masonic
Library and Museum Trust